

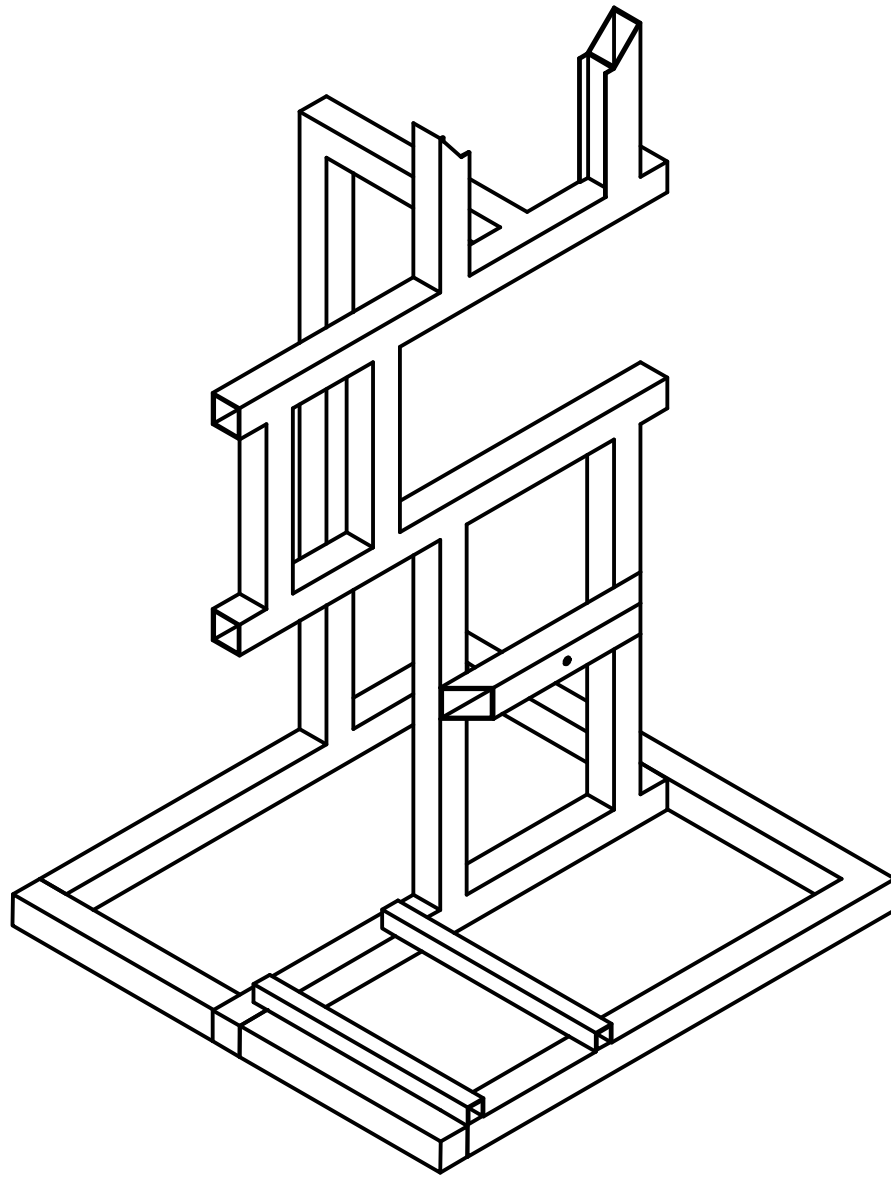

		2	Roda Sepeda	10	Aluminium	Ø 38 cm	Dibeli	
		1	Mata Gergaji Pita	9	HSS	2360x 19x 0,9 mm	Dibeli	
		1	Motor Listrik	8	Besi Cor	0,5 Hp	Dibeli	
		1	V-Belt	7	Rubber	B-53	Dibeli	
		1	Pulley	6	ST37	Ø4 dan Ø 6 inchi	Dibeli	
		2	Roller Pencekam	5	ST37	500x 50x 50 mm	Dibuat	
		1	Dudukan Benda Kerja	4	ST37	800x 50x 50 mm	Dibuat	
		1	Pengait Roda Bawah	3	ST37	1600x 50x 50 mm	Dibuat	
		1	Pengait Roda Atas	2	ST37	375x 50x 50 mm	Dibuat	
		1	Kerangka	1	ST37	1200x 50x 50 mm	Dibuat	
		Jumlah	Nama bagian	No.Bag	Bahan	Ukuran	Keterangan	
III	II	I	Perubahan :					
			MESIN GERGAJI PITA				Skala 1:20	Digambar TIM 19-05-23 Diperiksa Mardiana
			POLITEKNIK NEGERI SRIWIJAYA				DRAME ASSEM/LA/2023	



Jumlah			Nama bagian	No.Bag	Bahan	Ukuran	Keterangan			
III	II	I	Perubahan :							
			ASSEMBLING KERANGKA			Skala 1:10	Digambar	TIM	19-05-23	
							Diperiksa	Mardiana		
POLITEKNIK NEGERI SRIWIJAYA						DRAME 01/ASSEM/LA/2023				

1.1  Welding
Tol ± 0,5

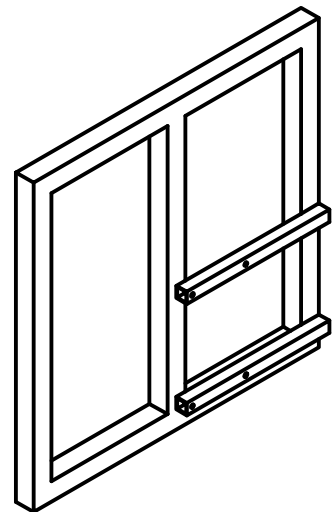
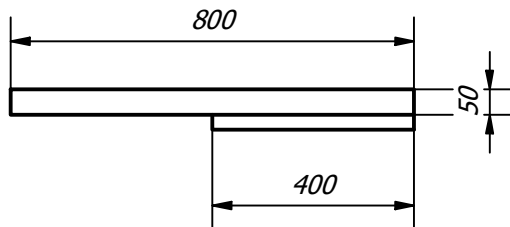
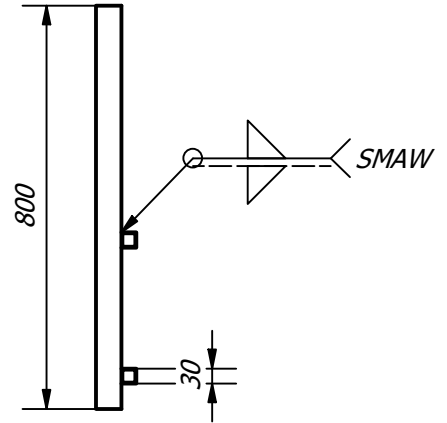
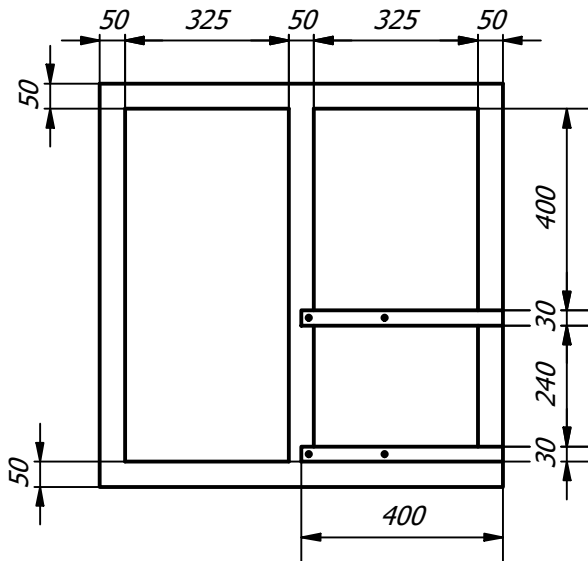

		2	Penyangga Motor Listrik	1.1.3	ST37	400x30x30 mm	Dibuat	
		1	Alas Tengah	1.1.2	ST37	700x50x50 mm	Dibuat	
		4	Alas Samping	1.1.1	ST37	3200x50x50 mm	Dibuat	
Jumlah		Nama bagian		No.Bag	Bahan	Ukuran	Keterangan	
III	II	I	Perubahan :					
KERANGKA BAGIAN BAWAH						Skala 1:15	Digambar TIM	19-05-23
							Diperiksa Mardiana	
POLITEKNIK NEGERI SRIWIJAYA						DRAME 01/ASSEM/LA/2023		

1.1.1 Gerinda
Tol ± 0,5

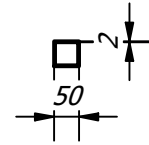
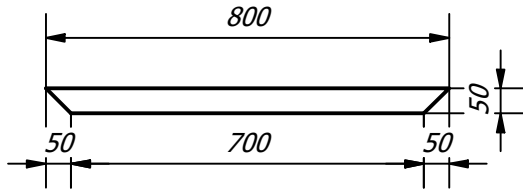

1.1.2 Gerinda
Tol ± 0,5

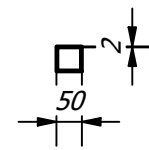
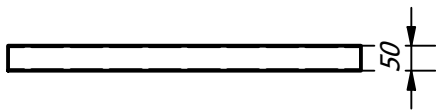
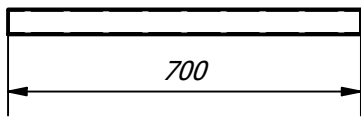
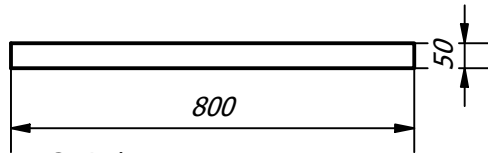

1.1.3 Gerinda-Bor
Tol ± 0,5

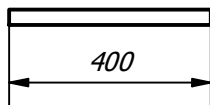
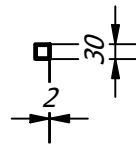
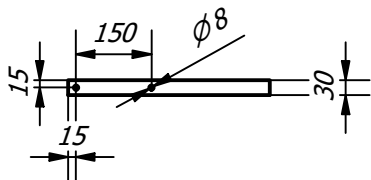

		2	Penyangga Motor Listrik	1.1.3	ST37	850x30x30 mm	Dibuat	
		1	Alas tengah	1.1.2	ST37	750x50x50 mm	Dibuat	
		4	Alas samping	1.1.1	ST37	3500x50x50 mm	Dibuat	
Jumlah		Nama bagian		No.Bag	Bahan	Ukuran	Keterangan	
III	II	I	Perubahan :					
UNIT KERANGKA BAGIAN BAWAH						Skala 1:15	Digambar TIM	19-05-23
							Diperiksa Mardiana	
POLITEKNIK NEGERI SRIWIJAYA						DRAME 01/PART/LA/2023		

1.2  Welding
Tol ± 0,5

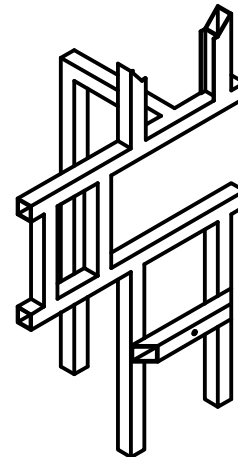
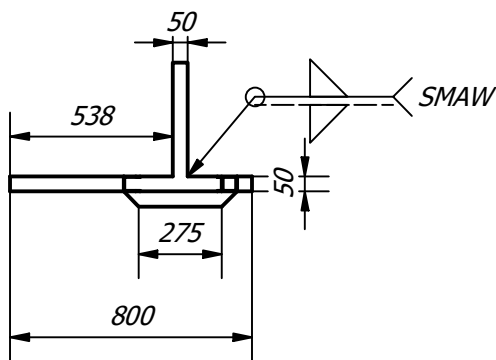
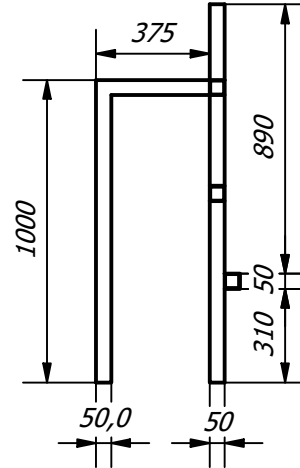
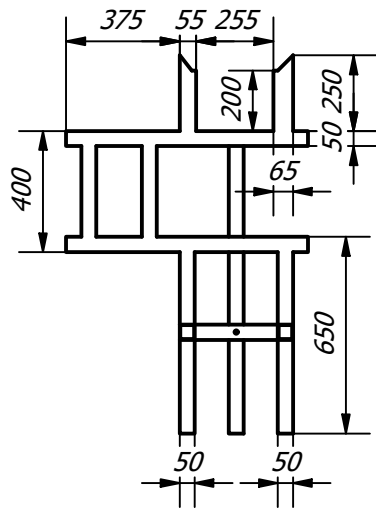

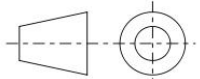
		1	Penyangga Kerangka	1.2.6	ST37	1375x50x50 mm	Dibuat	
		2	Penyangga Pengait Roda Atas	1.2.5	ST37	500x50x50 mm	Dibuat	
		2	Penyangga Tengah	1.2.4	ST37	800x50x50 mm	Dibuat	
		2	penyangga Pelintang	1.2.3	ST37	1600x50x50 mm	Dibuat	
		1	Penyangga Roda Bawah Dalam	1.2.2	ST37	375x50x50 mm	Dibuat	
		2	Tiang Bawah	1.2.1	ST37	1200x50x50 mm	Dibuat	
		Jumlah	Nama bagian	No.Bag	Bahan	Ukuran	Keterangan	
III	II	I	Perubahan :					
			KERANGKA BAGIAN ATAS			Skala 1:15	Digambar TIM	19-05-23
						Diperiksa Mardiana		
			POLITEKNIK NEGERI SRIWIJAYA			DRAME 01/ASSEM/LA/2023		

1.2.1 $\sqrt{\text{Gerinda}}$
Tol $\pm 0,5$

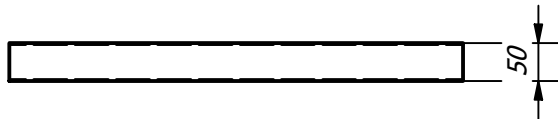
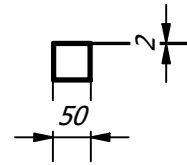
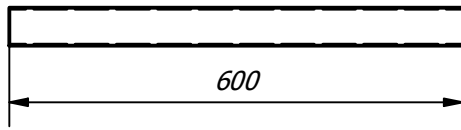

1.2.2 $\sqrt{\text{Gerinda-Bor}}$
Tol $\pm 0,5$

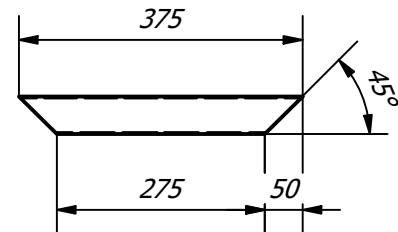
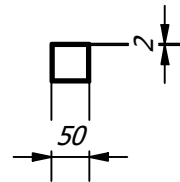
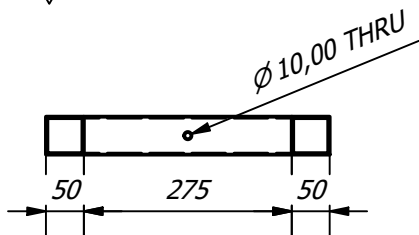

		1	Penyangga Roda Bawah Dalam	1.2.2	ST37	380x50x50 mm	Dibuat	
		2	Tiang Bawah	1.2.1	ST37	1250x50x50 mm	Dibuat	
Jumlah			Nama bagian	No.Bag	Bahan	Ukuran	Keterangan	
III	II	I	Perubahan :					
UNIT KERANGKA BAGIAN ATAS						Skala 1:10	Digambar TIM Diperiksa Mardiana	
POLITEKNIK NEGERI SRIWIJAYA						DRAME 01/PART/LA/2023		

1.2.3 $\sqrt{\text{Gerinda}}$
Tol $\pm 0,5$

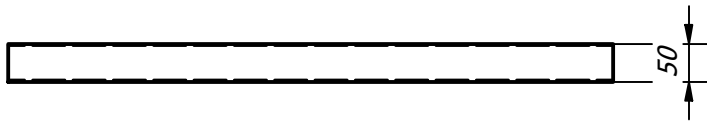
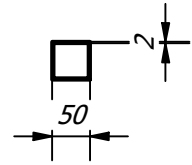
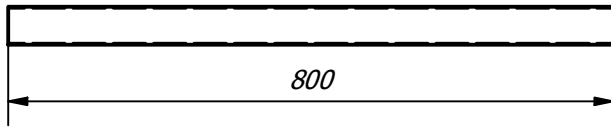

1.2.4 $\sqrt{\text{Gerinda}}$
Tol $\pm 0,5$

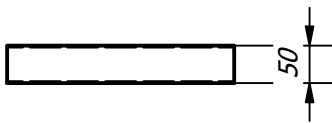
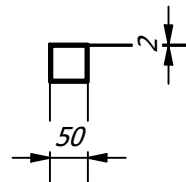
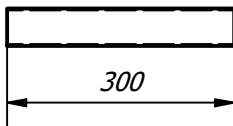

		2	Penyangga Tengah	1.2.4	ST37	480x50x50 mm	Dibuat	
		2	Penyangga pelintang	1.2.3	ST37	1700x50x50 mm	Dibuat	
Jumlah		Nama bagian		No.Bag	Material	Ukuran	Keterangan	
III	II	I	Perubahan :					
UNIT KERANGKA BAGIAN ATAS						Skala 1:10	Digambar TIM Diperiksa Mardiana	
POLITEKNIK NEGERI SRIWIJAYA						DRAME 01/PART/LA/2023		

Gerinda
 $1.2.5 \sqrt{\text{Tol} \pm 0,5}$

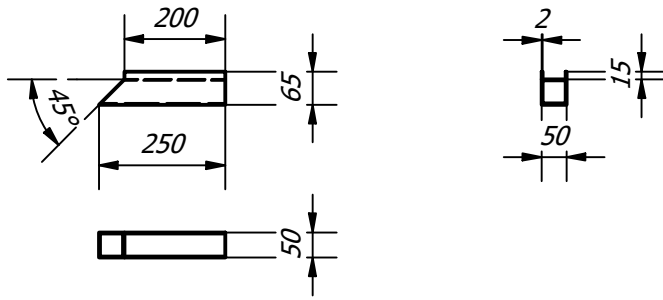

Gerinda
 $1.2.6 \sqrt{\text{Tol} \pm 0,5}$

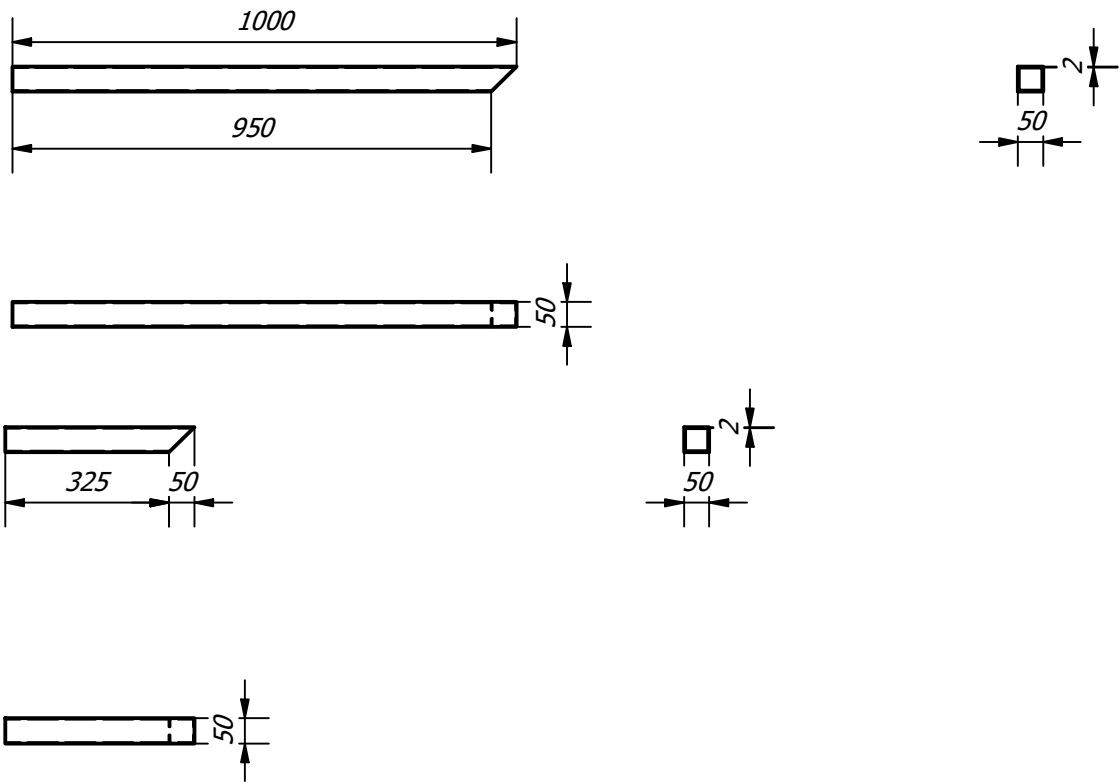

		2	Penyangga Kerangka	1.2.6	ST37	550x50x50 mm	Dibuat	
		2	Penyangga Pengait Roda Atas	1.2.5	ST37	1380x50x50 mm	Dibuat	
		Jumlah	Nama bagian	No.Bag	Bahan	Ukuran	Keterangan	
III	II	I	Perubahan :					
			UNIT KERANGKA BAGIAN ATAS			Skala 1:15	Digambar TIM Diperiksa Mardiana	
			POLITEKNIK NEGERI SRIWIJAYA			DRAME 01/PART/LA/2023		

2.  *Welding*
Tol ± 0,5

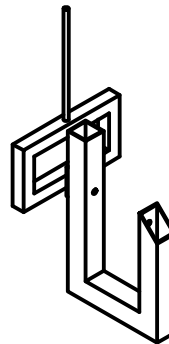
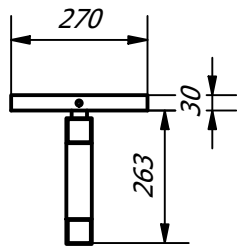
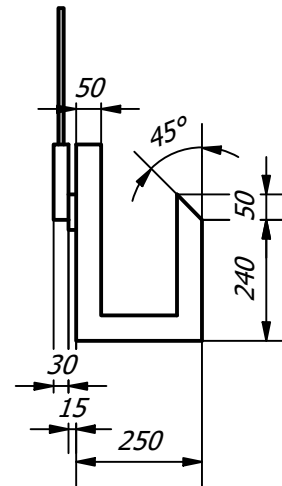
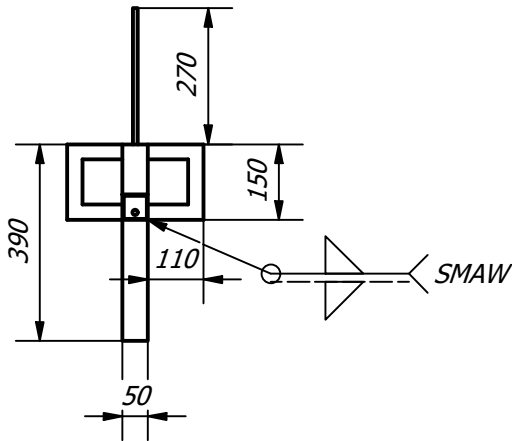

		1	Baut M10	2.3	ST37	M10x27 mm	Dibeli	
		1	Pengait Roda	2.2	ST37	885x50x50 mm	Dibuat	
		1	Penyangga Naik Turun	2.1	ST37	270x150x30 mm	Dibuat	
Jumlah		Nama bagian		No.Bag	Bahan	Ukuran	Keterangan	
III	II	I	Perubahan :					
PENGAIT RODA ATAS						Skala 1:15	Digambar TIM	19-05-23
							Diperiksa Mardiana	
POLITEKNIK NEGERI SRIWIJAYA						DRAME 02/ASSEM/LA/2023		

2.1 $\sqrt{\text{Gerinda}}$
Tol $\pm 0,5$

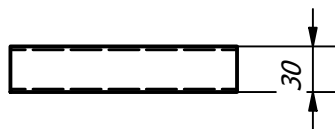
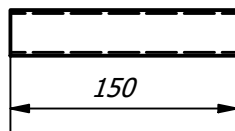
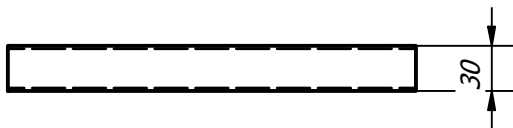
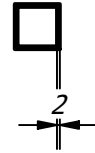
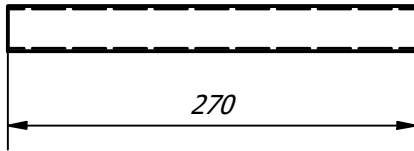

		2	Penyangga Naik Turun	2.1	ST37	450x30x30 mm	Dibuat		
	Jumlah		Nama bagian	No.Bag	Material	Ukuran	Keterangan		
III	II	I	Perubahan :						
			UNIT PENGAIT RODA ATAS			Skala 1:5	Digambar	TIM	19-05-23
							Diperiksa	Mardiana	
			POLITEKNIK NEGERI SRIWIJAYA			DRAME 02/PART/LA/2023			

2.2 $\sqrt{\text{Gerinda - Bor}}$
 Tol $\pm 0,5$

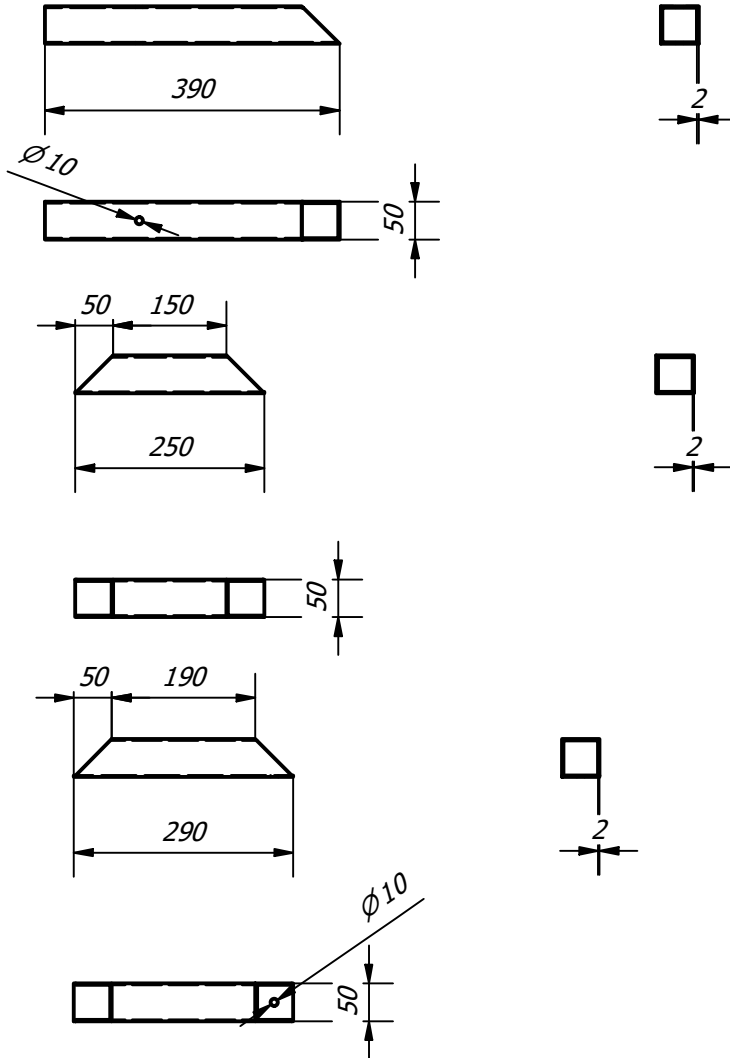

		3	Pengait Roda	2.2	ST37	950x50x50 mm	Dibuat	
Jumlah			Nama bagian	No.Bag	Material	Ukuran	Keterangan	
III	II	I	Perubahan :					
UNIT PENGAIT RODA ATAS						Skala 1:5	Digambar TIM	19-05-23
							Diperiksa Mardiana	
POLITEKNIK NEGERI SRIWIJAYA						DRAME 02/PART/LA/2023		

3.1 $\sqrt{\text{Gerinda}}$
Tol $\pm 0,5$

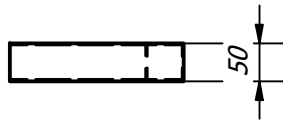
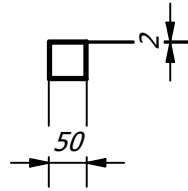
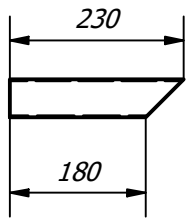

3.2 $\sqrt{\text{Gerinda-Bor}}$
Tol $\pm 0,5$

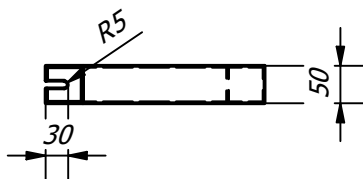
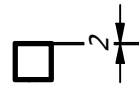
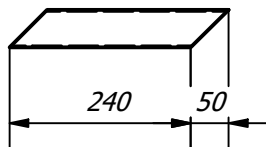

		1	Penyangga roda luar	3.2	ST37	300x50x50 mm	Dibuat	
		1	Penyangga roda bawah	3.1	ST37	300x50x50 mm	Dibuat	
		Jumlah	Nama bagian	No.Bag	Bahan	Ukuran	Keterangan	
III	II	I	Perubahan :					
			UNIT PENGAIT RODA BAWAH			Skala 1:10	Digambar TIM	19-05-23
						Diperiksa Mardiana		
			POLITEKNIK NEGERI SRIWIJAYA			DRAME 03/PART/LA/2023		

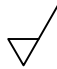
3.  *Welding*
Tol ± 0,5

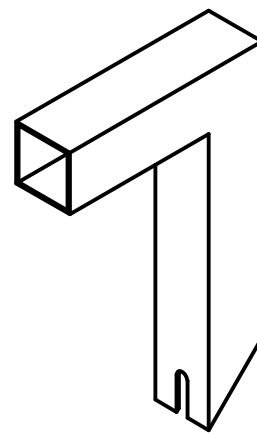
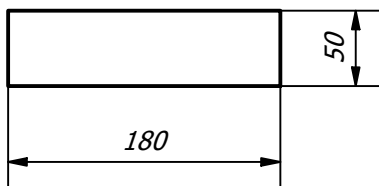
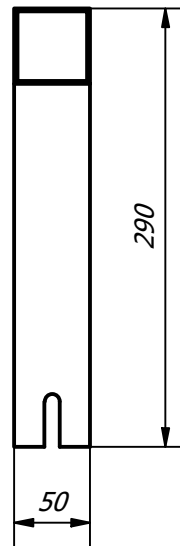
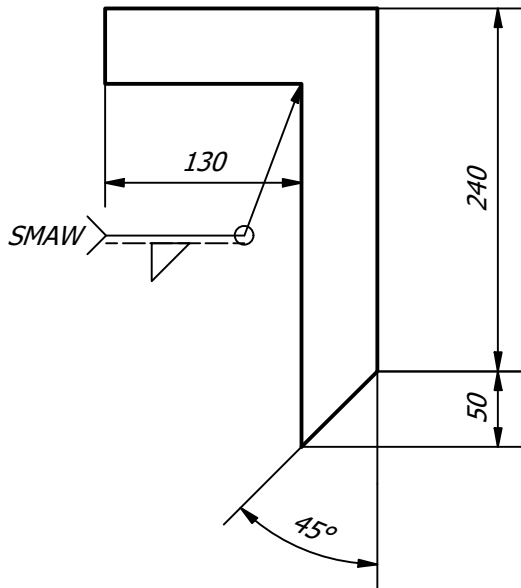

		1	Penyangga Roda Luar	3.2	ST37	290x50x50 mm	Dibuat		
		1	Penyangga Roda Bawah	3.1	ST37	230x50x50 mm	Dibuat		
Jumlah		Nama bagian		No.Bag	Bahan	Ukuran	Keterangan		
III	II	I	Perubahan :				 		
PENGAIT RODA BAWAH						Skala 1:5	Digambar	TIM	19-05-23
							Diperiksa	Mardiana	
POLITEKNIK NEGERI SRIWIJAYA						DRAME 03/ASSEM/LA/2023			

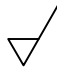
4.  *Welding*
Tol ± 0,5

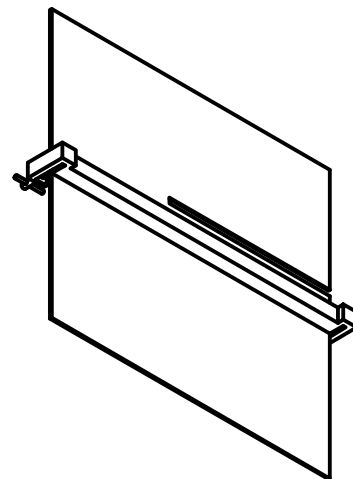
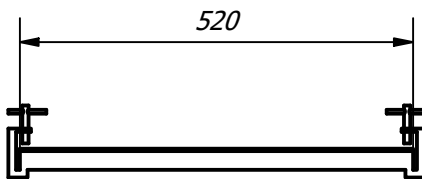
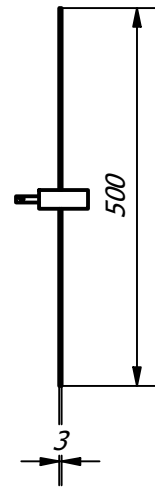
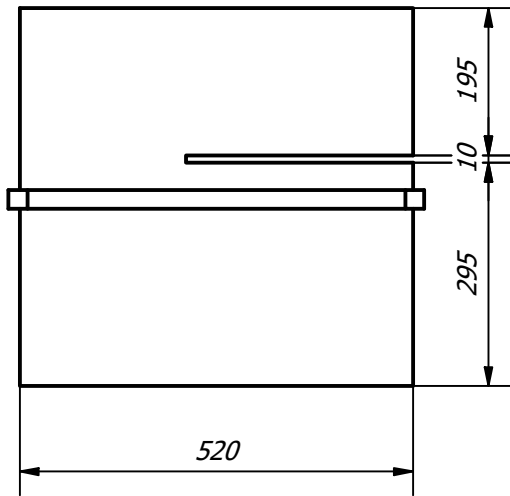

		1	Stopper	4.2	ST37	520x25x25 mm	Dibuat		
		1	Meja	4.1	ST37	520x500x3 mm	Dibuat		
		<i>Jumlah</i>	<i>Nama bagian</i>	<i>No.Bag</i>	<i>Bahan</i>	<i>Ukuran</i>	<i>Keterangan</i>		
III	II	I	<i>Perubahan :</i>						
			<i>Dudukan Benda Kerja</i>			<i>Skala</i> 1:15	<i>Digambar</i>	<i>TIM</i>	<i>19-05-23</i>
							<i>Diperiksa</i>	<i>Mardiana</i>	
<i>POLITEKNIK NEGERI SRIWIJAYA</i>						<i>DRAME 04/ASSEM/LA/2023</i>			

4.1 $\sqrt{\text{Gerinda}}$
Tol $\pm 0,5$

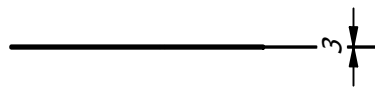
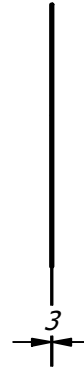
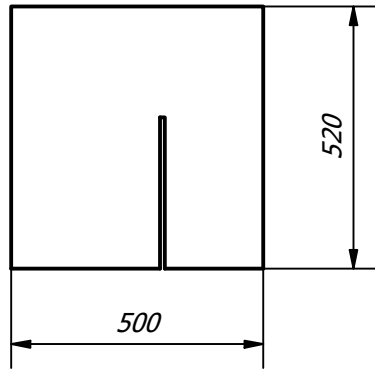

4.2 $\sqrt{\text{Gerinda}}$
Tol $\pm 0,5$

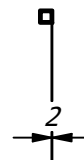
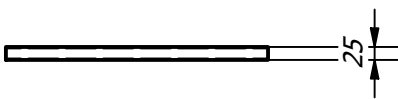
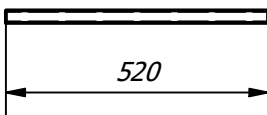

		1	Stopper	4.2	ST37	530x25x2 mm	Dibuat		
		1	Meja	4.1	Besi	700x600x3 mm	Dibuat		
		Jumlah	Nama bagian	No.Bag	Bahan	Ukuran	Keterangan		
III	II	I	Perubahan :						
			UNIT DUDUKAN BENDA KERJA			Skala 1:15	Digambar	TIM	19-05-23
							Diperiksa	Mardiana	
			POLITEKNIK NEGERI SRIWIJAYA			DRAME 04/PART/LA/2023			

4.1 $\sqrt{\text{Gerinda}}$
Tol $\pm 0,5$

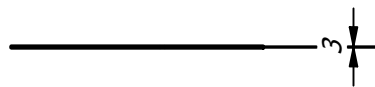
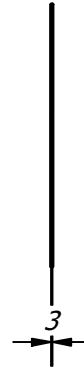
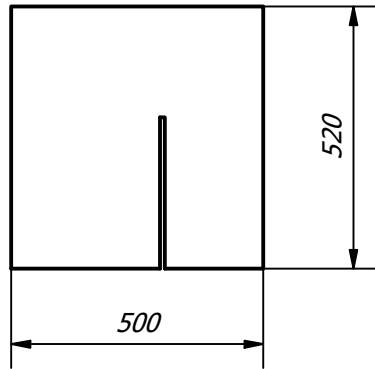

4.2 $\sqrt{\text{Gerinda}}$
Tol $\pm 0,5$

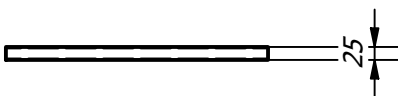
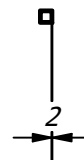
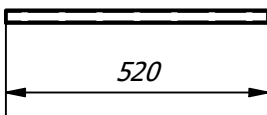

		1	Stopper	4.2	ST37	530x25x2 mm	Dibuat		
		1	Meja	4.1	Besi	700x600x3 mm	Dibuat		
		Jumlah	Nama bagian	No.Bag	Bahan	Ukuran	Keterangan		
III	II	I	Perubahan :						
			UNIT DUDUKAN BENDA KERJA			Skala 1:15	Digambar	TIM	19-05-23
							Diperiksa	Mardiana	
			POLITEKNIK NEGERI SRIWIJAYA			DRAME 04/PART/LA/2023			

5.  *Welding*
Tol ± 0,5

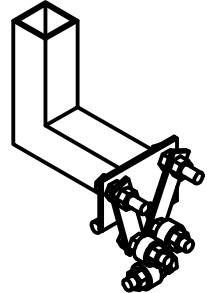
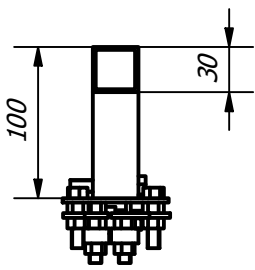
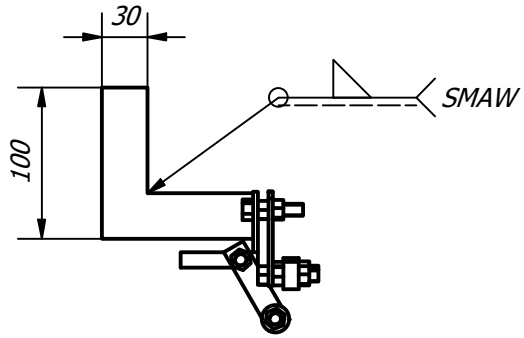
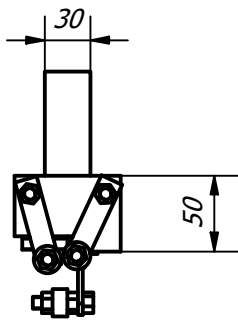

		6	Bearing 608 zz	5.6	Besi	Standar	Dibeli
		22	Mur M8	5.5	ST37	Standar	Dibeli
		6	Baut M8	5.4	ST37	Standar	Dibeli
		4	Lengan Penyangga	5.3	ST37	400x30x30 mm	Dibuat
		6	Lengan Bearing	5.2	ST37	360x15x3 mm	Dibuat
		2	Plat Dudukan	5.1	ST37	140x50x3 mm	Dibuat

Jumlah	Nama bagian	No.Bag	Bahan	Ukuran	Keterangan
--------	-------------	--------	-------	--------	------------

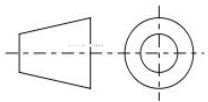
III	II	I	Perubahan :							
			ROLLER PENCEKAM				Skala 1:5	Digambar	TIM	19-05-23
								Diperiksa	Mardiana	
			POLITEKNIK NEGERI SRIWIJAYA				DRAME 05/ASSEM/LA/2023			

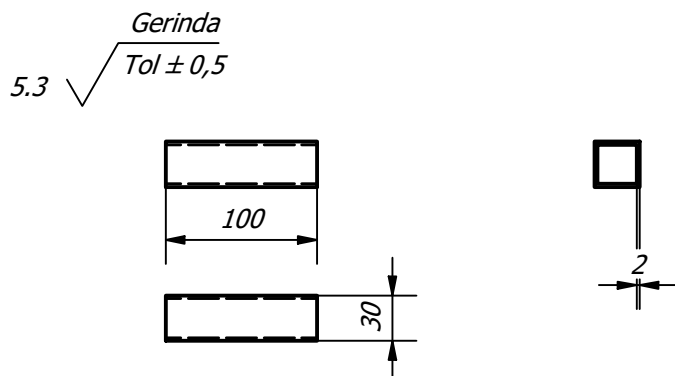
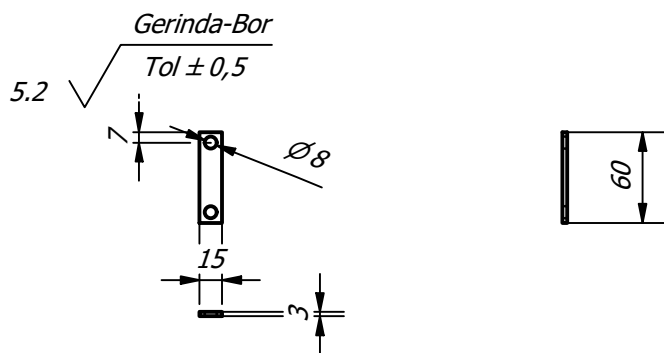
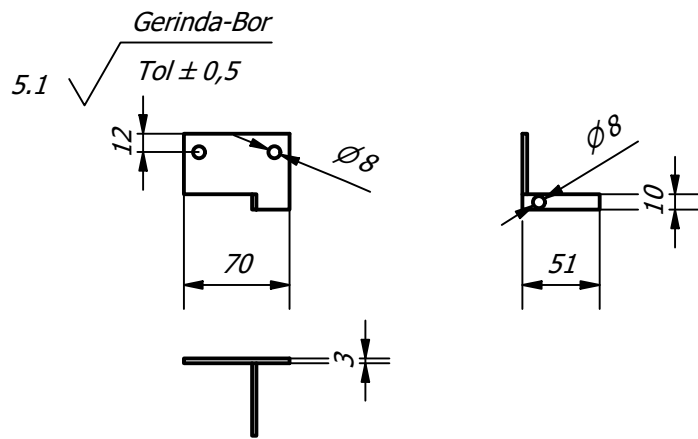

		4	Lengan Penyangga	5.3	ST37	450x30x30 mm	Dibuat		
		6	Lengan Bearing	5.2	ST37	400x15x3 mm	Dibuat		
		2	Plat Dudukan	5.1	ST37	70x100x3 mm	Dibuat		
Jumlah		Nama bagian		No.Bag	Bahan	Ukuran	Keterangan		
III	II	I	Perubahan :						
UNIT ROLLER PENCEKAM						Skala 1:5	Digambar	TIM	19-05-23
							Diperiksa	Mardiana	
POLITEKNIK NEGERI SRIWIJAYA						DRAME 05/PART/LA/2023			