

TOL  $\pm 0.1$  

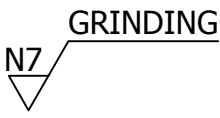
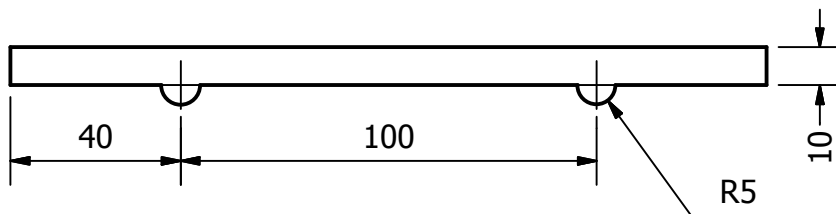
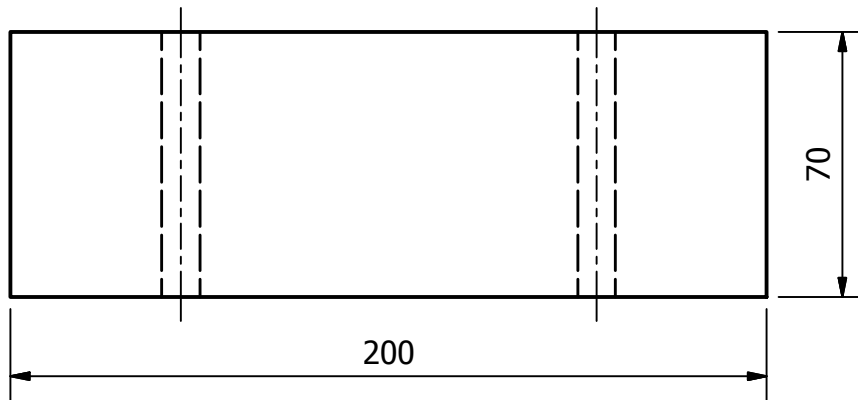

		2	Plat Penahan Bearing	1	Steel-Mild	200X70X10	Dibuat		
Jumlah			<u>Nama Bagian</u> Part Name	<u>No. Bag</u> Part No	<u>Bahan</u> Material	<u>Ukuran</u> Size	<u>Keterangan</u> Remark		
III	II	I	Perubahan Revision						
<b>PLAT PENAHAN BEARING</b>						Skala Scale 1 : 2			Digambar Drawn
						Diperiksa Checked	21/04/14	TRI/SF	
Politeknik Negeri Sriwijaya JL. Srijaya Negara Besar Palembang Web Site : www.polsri.ac.id						DRA ME INV PART No.006 /2014			