

No.3 Tol±0.01 ∇ N7 Milling

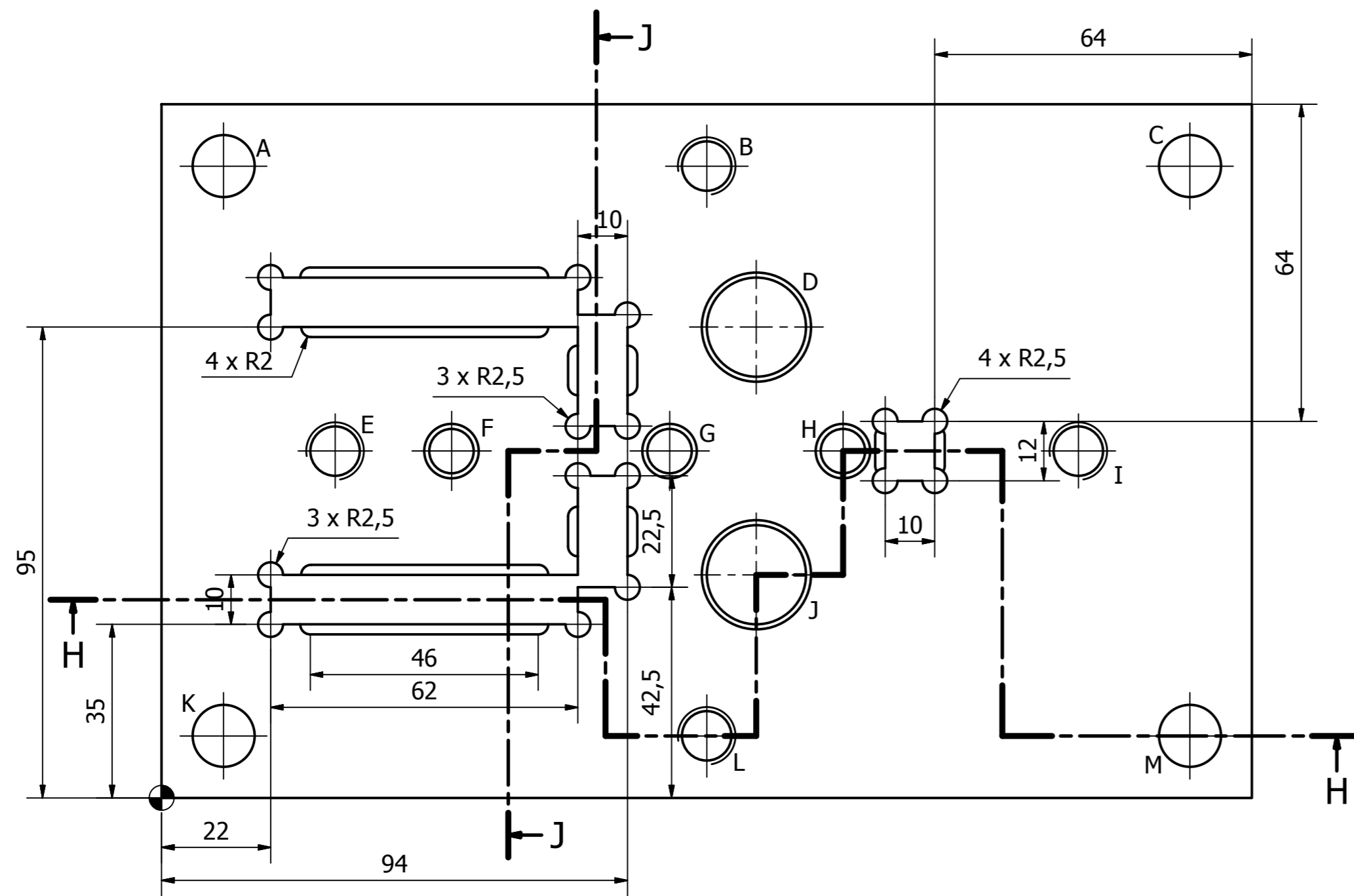

POT J-J

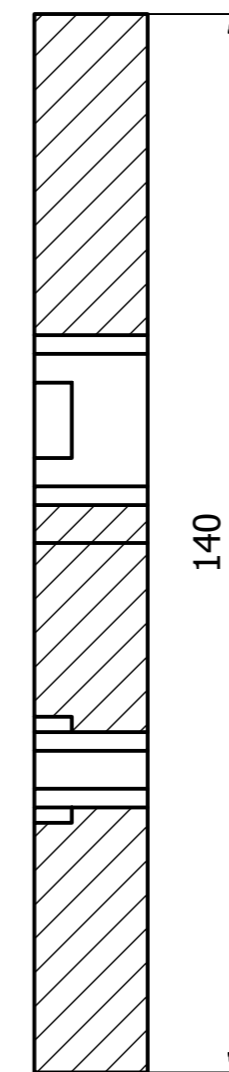

POT H-H

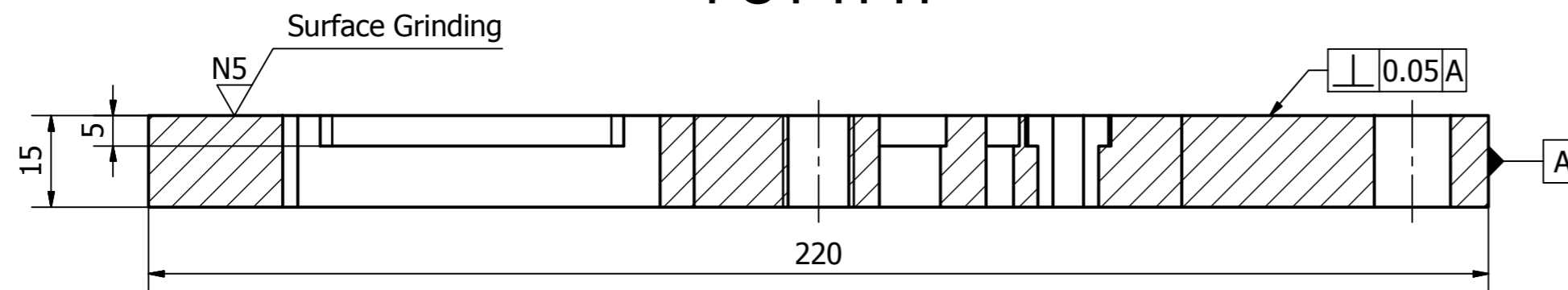

Tabel Lubang

RINCIAN	A	B	C	D	E	F	G	H	I	J	K	L	M
X	12.5	110	207.5	120	35	58.5	102.5	137.5	185	120	12.5	110	207.5
Y	127.5	127.5	127.5	95	70	70	70	70	70	45	12.5	12.5	12.5
Dim 1	12.5H7	M10	12.5H7	22	M10	11	11	11	M10	22	12.5H7	M10	12.5H7
Dim 2	-	-	-	20H7	-	9H7	9H7	9H7	-	20H7	-	-	-

	I	Punch Holder	3	ST42	230 x 150 x 15	Dibuat	
Jumlah <i>Quantity</i>		Nama Bagian <i>Part Name</i>	No. Bagian <i>Part No.</i>	Bahan <i>Material</i>	Ukuran <i>Dimension</i>	Keterangan <i>Explanation</i>	
I	II	Perubahan:					
	III						
<p align="center">PROGRESSIVE TOOL</p>					Skala <i>Scale</i> 1 : 1	Digambar <i>Drawn</i>	TEAM
					<p align="center">Politeknik Negeri Sriwijaya Jalan Srijaya Negara Bukit Besar Palembang 30139 Telp: +620711353414 web: http://www.polsri.ac.id E-mail: info@polsri.ac.id</p>		Diperiksa <i>Checked</i>
						DRA TA 07/2016 MA	