

Manual Book Timer

WEEKLY PROGRAMMABLE TIMER

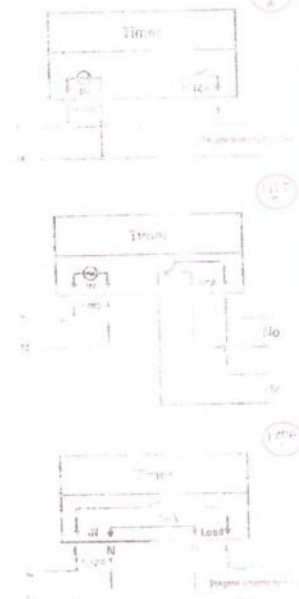

CONNECTION DIAGRAM



SIZE



DIN Rail Installation

- Advanced pre-setting one week before
- Digital electronic time switch with daily programs
- Repeat programs with 16 on/off setting and manual over-ride
- Lithium battery power reserve
- Auto time error correction $\pm 85\text{sec./week}$

Unlock instructions

Press the "C/R" button for the four times, and the "B" character disappears in the lower left corner of the display screen. At this time, the control switch is to unlock the state. All keys are valid, can be set or other operation. If not operated in 15 seconds, the time controlled switch is automatically locked. Such as finish setting up, you can also press the "C/R" button for four times, after manual lockbutton is invalid.

TECHNICAL DATA

- Voltage rating: AC 220V 50/60Hz
- Voltage limit: AC 180V-250V
- Hysteresis: $\leq 1\text{ sec/day}(25^\circ\text{C})$
- ON/OFF operation: 16 ON& 16 OFF
- Power consumption: 2VA (max)
- Display: LCD
- Service life: Mechanical 10'
- Electrically 10'
- Minimum interval: 1 minute
- Weight: approx 40g

Over voltage

- 2V, 2V, 36V, 48V, 110V;
- Count down: 1 sec-99 min 56 sec
- Pulse: 1 sec-59 min 59 sec
- Load capacity: relative load: 16A/25V AC
- Lagging load: 10A/250V ac
- Lamp load: 2000W
- Switching contact: 1 changeover switch
- Power reserve: 3 years (Lithium battery)
- Ambient temperature: $-10\text{--}40^\circ\text{C}$
- Ambient humidity: 35-85%RH

DISPLAY



1	⊕	TIMER
2	D=	DAY
3	H=	HOUR
4	M=	MIN
5	⊖	CLOCK
6	C	RESET
7	MANUAL	MANUAL, C/R
8	C/R	CANCEL, C/R

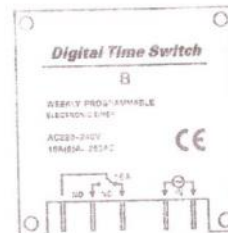

Operating Instruction

- To start switch, press reset key. At the first time, if you want to the present time, please press "⊕" On board, then press D, H, M to adjust the number to the present time.
- Enter into programming as belows:

Step	Key	Programming
1	Press P	Setting 1 ON time (display 1 on)
2	Press H+/M+	Setting hours and minutes
3	Press D+	To select same day, or different time each day
4	Press P	Setting 1 off time (display 1 off)
5	Press H+/M+	Setting hours and minutes turn off time
6	Press D+	If you want the same every day, you need not press this key
7	Repeat step 2-6	Set 2-16 on/off time
8	Press ⊕	End

If you do not require 16 settings, press "⊕" to the end.

NOTE:

- Time setting should according to the time sequence, couldn't be set crossly
- System with quit automatically if there's no operating within 10 seconds and no time is saved.
- Operation 3, 4, 5 can not be used simultaneously.

Gambar Rangkaian Relay



Gambar rangkaian Sensor Cahaya LDR

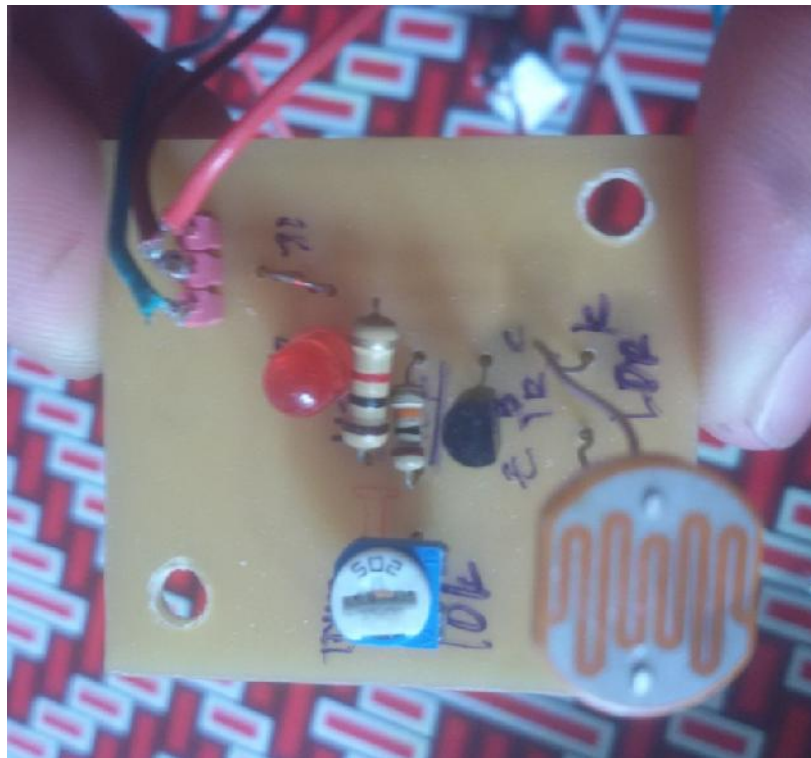

Gambar Layout Sensor Cahaya LDR



Gambar Catu Daya

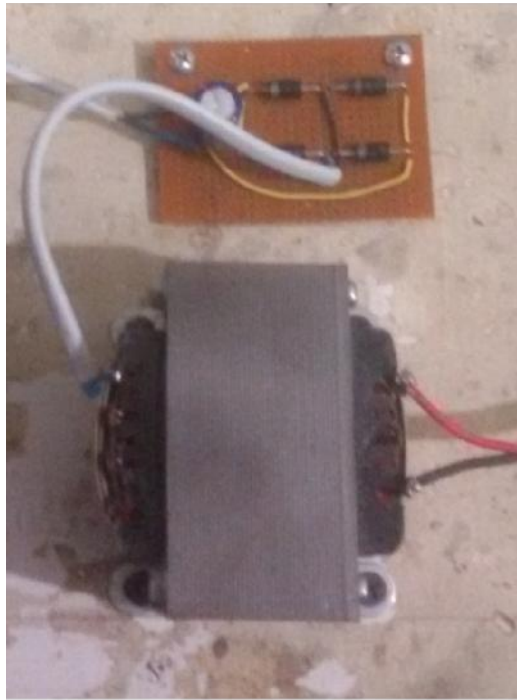

Gambar Panel Kontrol



Gambar Proses Pembuatan Box Tirai



Gambar Mekanik Penggerak Tirai



Gambar Pemasangan Motor Power Window

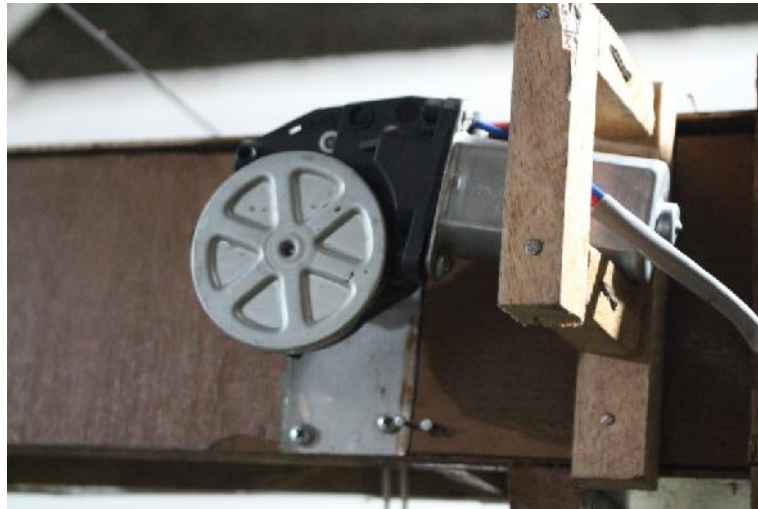

Gambar Pembuatan Tiang Penyangga



Gambar Tirai Otomatis Pada Rumah Tinggal

