

GMX023 DC Gear Motor 3-12V, 1:120, 100rpm, Offset Shaft

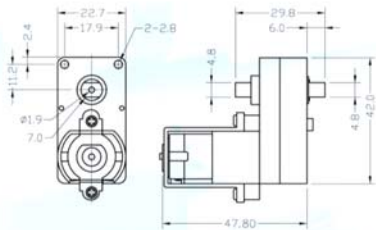

Gear ratio	: 1:120
Operating voltage	: 3 – 12 V DC
Working voltage	: 5 V DC
No load current @ 5VDC	: 200mA
No load speed@5VDC	: 100rpm
Output torque@5VDC	: 3 kgf.cm
Stall current@5VDC	: 2.3A
Stall torque@5VDC	: -
Weight	: 33 g